

# OFFICE SPACE FOR LEASE 701 ALLEN STREET

701 S. ALLEN STREET • MERIDIAN, IDAHO 83642



## PROPERTY INFORMATION:

<b>Submarket:</b>	Meridian	<b>Lease Term:</b>	3-5 Years
<b>Bldg Type:</b>	Office	<b>Lease Type:</b>	FLSV less janitorial
<b>Bldg Size:</b>	26,244 SF	<b>Available:</b>	Immediately
<b>Parking:</b>	7.5/1,000	<b>Divisible:</b>	No

## AVAILABLE SPACE:

SPACE:	RSF	RATE
Suite 106B	2,275 SF	\$11.00/SF
Suite 102	3,428 SF	\$15.00/SF
Suite 200*	1,188 SF	\$8.00/SF

\*Located in adjacent building (shown in photo on page 3).  
See separate lockbox on building for showing.

Contact Agent for lockbox code on main building.

## CONTACT:

**Nick Schuitemaker**

Ph: 208.947.0802  
nick@tokcommercial.com

**Peter Oliver, SIOR, CCIM**

Ph: 208.947.0816  
peter@tokcommercial.com

**Mike Greene, SIOR, CCIM**

Ph: 208.947.0835  
mikeg@tokcommercial.com



## LISTING COMMENTS:

Stop light access.

On-site storage available.

Ample parking of 7.5 per 1,000.

Less than 1 mile to I-84 interchange.

Located off Eagle Road near St. Luke's Regional Medical Center.

# OFFICE SPACE FOR LEASE 701 ALLEN STREET

701 S. ALLEN STREET • MERIDIAN, IDAHO 83642

## FLOOR PLAN

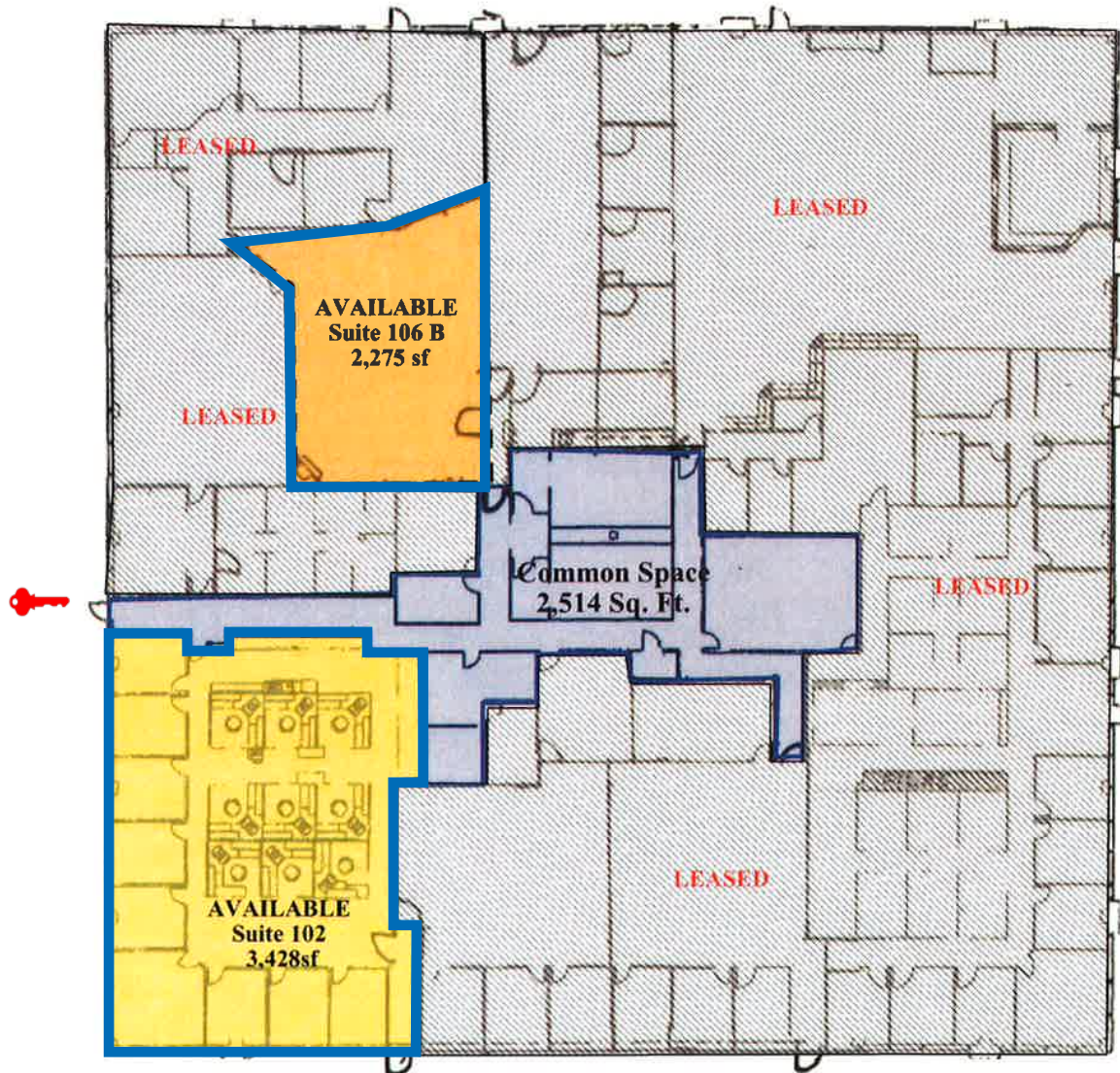

Lockbox

This information was obtained from sources believed reliable but cannot be guaranteed. Any opinions or estimates are used for example only.



# OFFICE SPACE FOR LEASE 701 ALLEN STREET

701 S. ALLEN STREET • MERIDIAN, IDAHO 83642



This information was obtained from sources believed reliable but cannot be guaranteed. Any opinions or estimates are used for example only.



# OFFICE SPACE FOR LEASE 701 ALLEN STREET

701 S. ALLEN STREET • MERIDIAN, IDAHO 83642



This information was obtained from sources believed reliable but cannot be guaranteed. Any opinions or estimates are used for example only.